

\*\*\*ALL TURF REPLACEMENT PROGRAM PROJECTS MUST INCLUDE A MINIMUM OF 3 PLANTS PER 100 SQUARE FEET OF TURF REMOVED AND AT LEAST ONE APPROVED SUSTAINABILITY FEATURE. REFER TO THE MWDOC TURF REMOVAL PROGRAM'S WEBSITE FOR MORE INFORMATION.

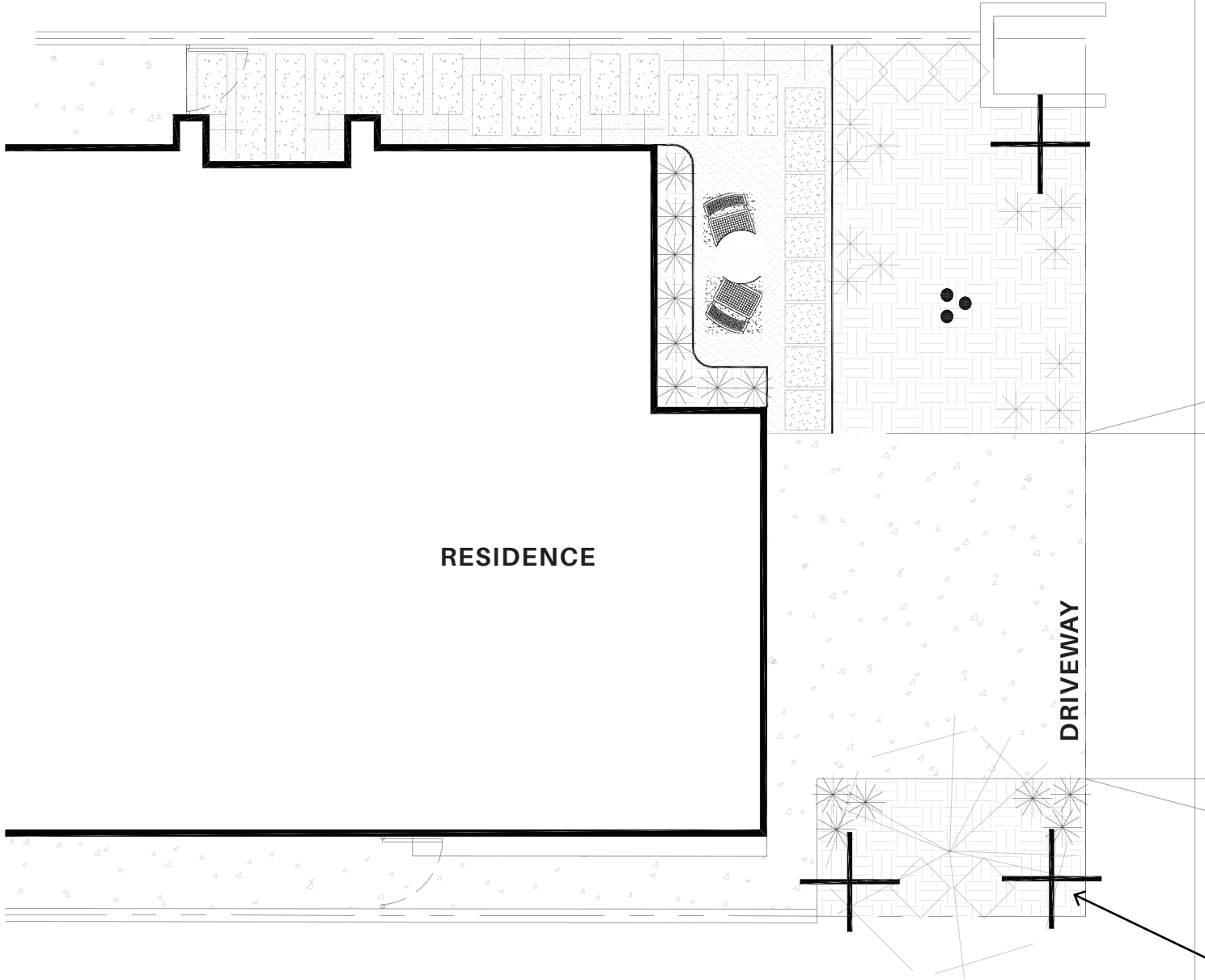

## SHRUB LEGEND (USDA ZONE 10a/b)(SUNSET 24)

SYM.	BOTANICAL NAME	COMMON NAME	SIZE	QTY	WUCOLS
	AGAVE 'BLUE GLOW'	BLUE GLOW AGAVE	5 GAL.	14	VERY LOW
	HESPERALOE PARVIFLORA	RED YUCCA	5 GAL.	5	VERY LOW
	ECHINOCACTUS GRUSONII	GOLDEN BARREL CACTUS	5 GAL.	12	VERY LOW
	JUNCUS PATENS	CALIFORNIA GRAY RUSH	1 GAL.	13	LOW
	MUHLENBERGIA RIGENS	DEERGRASS	1 GAL.	3	LOW
	SALVIA CHAMAEDRYOIDES	GERMANDER SAGE	1 GAL.	11	LOW

## TREE LEGEND (USDA ZONE 10a/b)(SUNSET 24)

SYM.	BOTANICAL NAME	COMMON NAME	SIZE	QTY	WUCOLS
	CALLISTEMON VIMINALIS	WEeping BOTTLEBRUSH	24" BOX	1	LOW
	ARBUTUS UNEDO	STRAWBERRY TREE	24" BOX	1	LOW

## HARDSCAPE AND MULCH LEGEND

SYMBOL	DESCRIPTION	QUANTITY	COLOR	FINISH
	DECOMPOSED GRANITE INORGANIC MULCH	APPROX. 146 SQ. FT.	DESERT GOLD	STABILIZED
	ORGANIC SHREDDED BARK MULCH	APPROX. 358 SQ. FT.	FOREST BLEND	N.A.
	NATURAL GRAY CONCRETE WITH #2 TOPCAST FINISH. CONCRETE PAVERS NOT TO EXCEED 3' X 3' IN SIZE AND TO BE SPACED AT LEAST 2" APART TO ALLOW FOR PERMEABILITY.	APPROX. 107 SQ. FT.	GREY	N.A.
	STEEL EDGING	APPROX. 40 L.F.	CORTEN	N.A.

### GENERAL PLANTING NOTES

- ALL BOXED TREES SHOULD BE SELECTED AND TAGGED BY THE HOMEOWNER.
- ALL LOCAL JURISDICTION STANDARDS AND SPECIFICATIONS SHOULD BE REVIEWED PRIOR TO PLANTING.
- THE CONTRACTOR SHOULD VERIFY ALL PLANT MATERIAL QUALITY AND QUANTITIES PRIOR TO INSTALLATION. THE CONTRACTOR IS TO BE RESPONSIBLE FOR THE CONTINUOUS PROTECTION OF ALL PLANT MATERIALS UPON ARRIVAL TO THE SITE.
- ALL TREES, SHRUBS, VINES AND GROUNDCOVER SHALL BE SPOTTED UNDER THE DIRECTION OF THE HOMEOWNER.
- CONTRACTOR IS TO SPOT ALL PLANT MATERIAL AND HAVE THE HOMEOWNER APPROVE LOCATION PRIOR TO EXCAVATION OF ANY PLANT PIT. ALLOW 48 HOURS LEAD TIME. ANY TREE, SHRUB OR VINE THAT IS PLANTED WITHOUT APPROVAL OF THE HOMEOWNER MAY BE MOVED AT THE CONTRACTOR'S EXPENSE.
- THE LANDSCAPE CONTRACTOR IS RESPONSIBLE FOR THE CORRECT HEIGHT OF ROOT BALL ABOVE GRADE.
- LANDSCAPE CONTRACTOR SHOULD ADJUST TREE LOCATIONS IF THERE IS A CONFLICT WITH SUBSURFACE DRAIN LINES OR STORM DRAINS.
- THIRTY (30) DAYS AFTER INSTALLATION, ALL LANDSCAPE AREAS SHALL BE FERTILIZED WITH A COMMERCIAL GRADE FERTILIZER OF 16-6-8 OR HOMEOWNER APPROVED EQUAL, APPLIED PER MANUFACTURER'S RECOMMENDATIONS AND SPECIFICATIONS.
- ALL NEW HARDSCAPE AREAS SHOULD SHEET FLOW @ 2% MINIMUM OR DRAIN TO LANDSCAPE.
- ALL TREES THAT ARE CLOSER THAN FIVE FEET (5') TO HARDSCAPE ELEMENTS SHOULD BE PLANTED WITH A HOMEOWNER APPROVED LINEAR ROOT BARRIER.
- MWDOC MAKES NO REPRESENTATIONS OR WARRANTIES REGARDING THE CONTRACTED SERVICES OR PRODUCTS THAT YOU MAY SELECT UNDER THE TREE INCENTIVE PROGRAM, INCLUDING AS TO THE HEALTH, LIFESPAN, POWERLINE INTERFERENCE, AND/OR ROOT INTRUSION OF SIDEWALKS AND/OR OTHER HARDSCAPE OF ANY APPROVED TREES THAT MAY BE INSTALLED AS PART OF THE PROGRAM.
- ALL PROJECTS MUST INCLUDE A MINIMUM OF 3 PLANTS PER 100 SQUARE FEET OF TURF REMOVED AND AT LEAST ONE PROGRAM-ELIGIBLE SUSTAINABILITY FEATURE.
- LANDSCAPE CONTRACTOR SHOULD SUBMIT MULCH SAMPLE TO HOMEOWNER PRIOR TO DELIVERY AND INSTALLATION.

ALL TREES, SHRUBS, GROUNDCOVERS, PLANTERS, MATERIALS, ETC TO BE FIELD VERIFIED AND IF SITE CONDITIONS VARY FROM PLAN OR CONFLICT WITH TREES, UTILITIES, AND/OR SITE AMENITIES CONTACT HOMEOWNER IMMEDIATELY.



CONCEPTUAL IMAGERY



PLANT MASSING



PLANT MASSING



CONCRETE STEPPERS / PATHWAY  
NOT TO EXCEED 3' X 3' IN SIZE  
SPACED AT LEAST 2" APART

MATERIALS

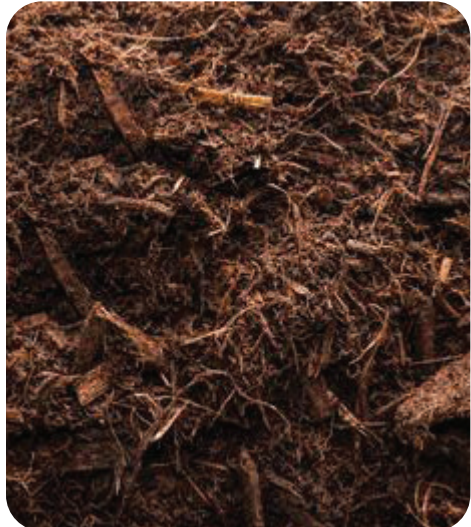

ORGANIC SHREDDED BARK MULCH



DECOMPOSED GRANITE

TREES



SUSTAINABILITY FEATURE:  
ARBUTUS UNEDO  
STRAWBERRY TREE



SUSTAINABILITY FEATURE:  
CALLISTEMON VIMINALIS  
WEeping BOTTLEBRUSH

MEDIUM / LARGE SHRUBS



JUNCUS PATENS  
COMMON RUSH



MUHLENBERGIA RIGENS  
DEER GRASS

SUCCULENTS / GROUNDCOVERS



HEPERALOE PARVIFLORA  
RED YUCCA



AGAVE BLUE GLOW



SALVIA CHAMAEDRYOIDES  
GERMANDER SAGE



ECHINOCACTUS GRUSONII  
GOLDEN BARREL CACTUS



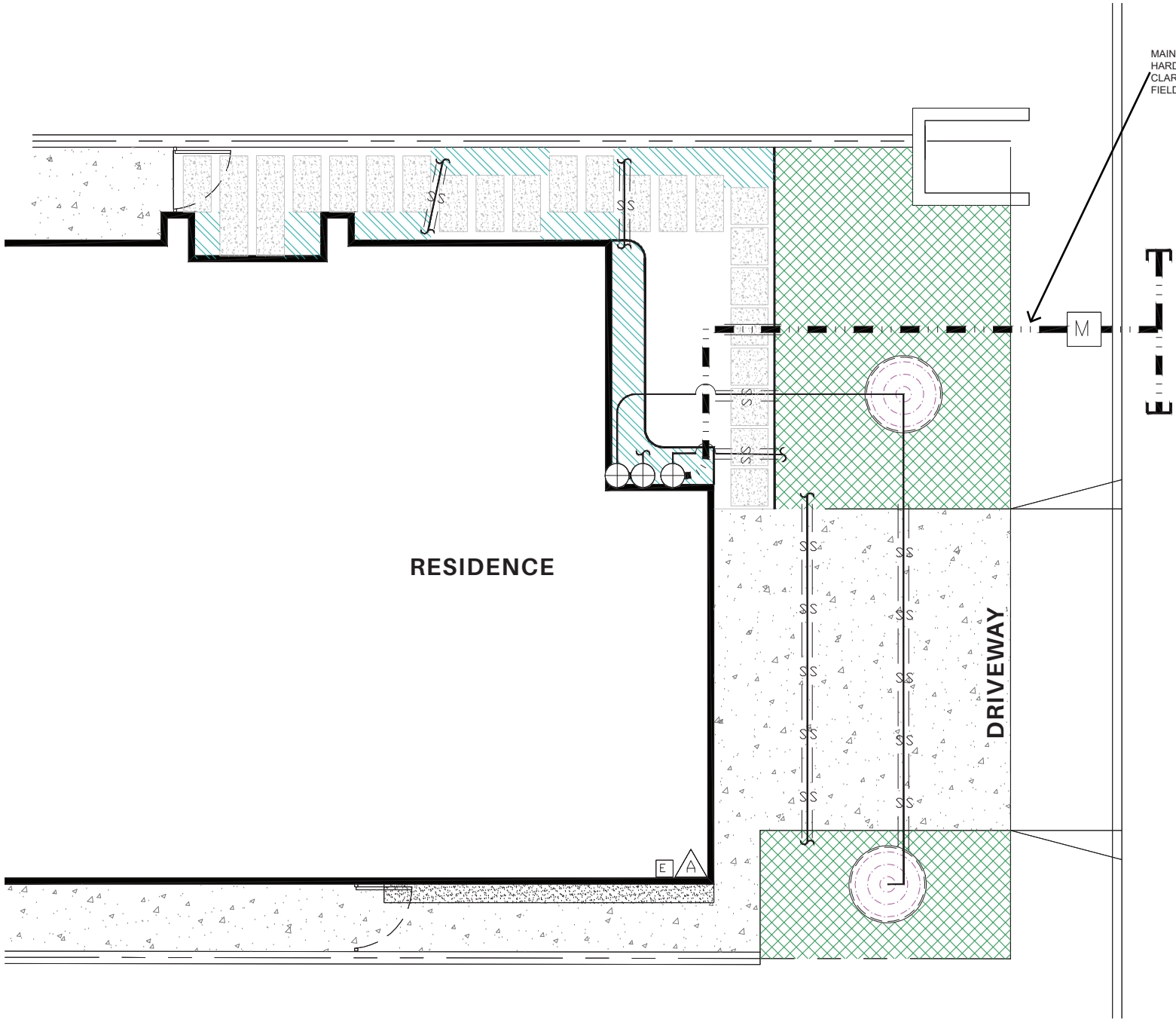

- GENERAL IRRIGATION NOTES
1.

THE IRRIGATION SYSTEM DESIGN IS BASED ON A MINIMUM OPERATING PRESSURE OF 70 PSI AT THE POC. CONTRACTOR SHALL VERIFY WATER PRESSURE PRIOR TO CONSTRUCTION. IF A DIFFERENT PRESSURE IS FOUND, REPORT IMMEDIATELY TO HOMEOWNER.
2.

THE IRRIGATION DESIGN IS DIAGRAMMATIC. ALL PIPING, VALVES, ETC. SHOWN WITHIN PAVED AREAS ARE FOR CLARIFICATION ONLY AND SHALL BE INSTALLED WITHIN PLANTING AREAS WHEREVER POSSIBLE.
3.

IT IS THE RESPONSIBILITY OF THE IRRIGATION CONTRACTOR TO BECOME FAMILIAR WITH ALL GRADE DIFFERENCES, LOCATION OF WALLS, RETAINING WALLS, STRUCTURES, AND UTILITIES. ALL CONTRACTORS SHALL REPAIR OR REPLACE ALL ITEMS DAMAGED BY THEIR WORK. WORK SHALL BE COORDINATED WITH OTHER CONTRACTORS FOR THE LOCATION AND INSTALLATION OF PIPE SLEEVES THROUGH WALLS, UNDER ROADWAYS, PAVING, AND ETC.
4.

DO NOT WILLFULLY INSTALL THE SPRINKLER SYSTEM AS SHOWN ON THE DRAWINGS WHEN IT IS OBVIOUS IN THE FIELD THAT UNKNOWN OBSTRUCTIONS, GRADE DIFFERENCES, OR DIFFERENCES ON SITE EXIST THAT ARE NOT SHOWN ON THE PLANS. SUCH OBSTRUCTIONS OR DIFFERENCES SHOULD BE BROUGHT TO THE ATTENTION OF THE HOMEOWNER. IN THE EVENT THAT NOTIFICATION IS NOT PERFORMED, THE IRRIGATION CONTRACTOR SHALL ASSUME FULL RESPONSIBILITY FOR ANY REVISIONS NECESSARY.
5.

ALL SPRINKLER EQUIPMENT SHALL BE INSTALLED AS PER MANUFACTURER'S RECOMMENDATIONS AND SPECIFICATIONS.

IRRIGATION UTILITIES

POINT OF CONNECTION (P.O.C.) TO DOMESTIC SERVICE LINE.

M

EXISTING

METER TO REMAIN.

EXISTING

HOSE BIB TO REMAIN.

IRRIGATION CONTROLLER

A

HUNTER

PRO-C PC-400 WALL MOUNT CONTROLLER with (1) PCM-300 and ROAM REMOTE.

E

BY OTHERS

120 VOLT ELECTRICAL POWER for CONTROLLER PROVIDED BY ELECTRICIAN, HOMEOWNER TO VERIFY AND APPROVE FINAL LOCATION.

SUB-SURFACE IRRIGATION

HUNTER

$\frac{3}{4}$ " PGV-ASV VALVE WITH  $\frac{3}{4}$ " HFR SYSTEM WITH 25 PSI REGULATOR

AS APPROVED

GATE VALVE - BLOCKED TRUE UNION PVC - 2" & SMALLER (LOCATE IN PLANTING AREAS - SHOWN FOR CLARITY ONLY)

HYDROZONE 1

HUNTER

HDL-06-12-100-CV DRIPLINE TUBING 0.6 GPH EMITTERS AT 12" ON CENTER SPACING - ALL TUBING SHALL BE INSTALLED ON GRADE W/ 9" WIRE STAKES TWO (2) FEET ON CENTER; VERIFY THE LAYOUT AND CENTER SPACING IN THE FIELD PRIOR TO STARTING WORK. INSTALL ON GRADE DRIP IRRIGATION SYSTEM per MANUFACTURER'S SPECIFICATIONS. CUT AND INSTALL TUBING TO ALLOW FOR MINIMUM OF 2 EMITTERS PER SHRUB, PREFERABLY 3 IN A TRIANGULAR PATTERN.

HYDROZONE 2

HUNTER

USE HUNTER PLD and PLD-LOC FITTINGS FOR CONNECTION BETWEEN PVC LATERAL LINES AND INLINE DRIP TUBING.

HUNTER

\* DRIP LINE LAYOUT NOTE:

NOT ALL SUPPLY/EXHAUST LATERALS SHOWN ON PLAN for GRAPHIC CLARITY - INSTALL LATERALS per MANUFACTURER'S SPECIFICATIONS and RECOMMENDATIONS TO AVOID LOW PRESSURE THROUGH DRIPPERLINE and CONNECTIONS.

HYDROZONE 3

HUNTER

DRIPLINE TREE RING - HDL-06-12-100-CV DRIPLINE TUBING .6 GPH EMITTERS AT 12" ON CENTER SPACING. TUBING SHALL BE INSTALLED ON GRADE W/ 9" WIRE STAKES TWO (1) FEET ON CENTER; VERIFY THE LAYOUT AND CENTER SPACING IN THE FIELD PRIOR TO STARTING WORK. INSTALL ON GRADE DRIP IRRIGATION SYSTEM PER MANUFACTURER'S SPECIFICATIONS. CUT AND INSTALL TUBING TO ALLOW FOR MINIMUM OF 2 EMITTERS PER SHRUB, PREFERABLY 3 IN A TRIANGULAR PATTERN.

HUNTER

AFV-T FLUSH VALVE. INSTALL VALVE INSIDE 6" ROUND VALVE BOX, ONE AT THE FAR END/LOW SIDE OF EACH PLANTER DRIP LINE LATERAL. INSTALL MINIMUM OF ONE FLUSH VALVE PER MAXIMUM OF 800' OF TUBING. MULTIPLE FLUSH VALVES MAY BE REQUIRED WITHIN DRIP LINE LAYOUT. ALWAYS INSTALL VALVES IN OPPOSITE DIRECTIONS OF THE PVC/DRIP CONNECTION MANIFOLD. REFER TO MANUFACTURER SPECIFICATIONS AND INSTALLATION GUIDELINES.

HUNTER

PLD-ARV AIR/VACUUM RELIEF VALVE - INSTALL AIR RELIEF ASSEMBLY INSIDE A 6" ROUND VALVE BOX AT THE HIGH POINT OF EACH PLANTER. MIN. 1 ARV PER 500' OF DISTRIBUTION TUBING. USING AIR RELIEF LATERAL. CONNECT AIR RELIEF VALVE TO ALL DRIP LINE LATERALS WITHIN THE ELEVATED AREA. REFER TO MANUFACTURER SPECIFICATIONS AND INSTALLATION GUIDELINES.

HUNTER

MULTIPLE ARV'S MAY BE REQUIRED PER RCV WITHIN UNDULATING AREAS, VERIFY QUANTITY PRIOR TO STARTING WORK, FLUSH VALVES and AIR RELIEF VALVES SHOWN DIAGRAMMATICALLY, INSTALL VALVE BOX 18" FROM PAVING AND AT HIGH POINTS OF PLANTER AREA.

HUNTER

ECO-INDICATOR INSTALLED ON EVERY STATION.

HUNTER

WSS-SEN WIRELESS SOLAR SYNC SENSOR with WIRELESS RECEIVER. INSTALL per MANUFACTURER SPECIFICATIONS.

NOTE: WHENEVER POSSIBLE HARD WIRE MODEL PREFERRED (MODEL #: SOLAR-SYNC).

IRRIGATION PIPING

AS APPROVED

NON-PRESSURE LATERAL SCH. 40 PVC PIPE. FOR SIZES 3/4" - 2" W/ PVC SCH. 40 FITTINGS - BURY MIN. 12" BELOW GRADE, SEE DETAIL FOR SLEEVING AND DEPTHS. SEE SYMBOL AND PLAN FOR SLEEVING LOCATIONS.

AS APPROVED

EXISTING MAINLINE TO REMAIN.

AS APPROVED

NOTE:

PRESSURE RELIEF VALVES SHALL BE INSTALLED AT ALL IRRIGATION MAINLINE PIPING "DEAD-ENDS" AND "RIGHT ANGEL" TURNS TO PREVENT WATER HAMMER DAMAGE TO PIPE AND FITTINGS. USE THRUST BLOCKS TO PREVENT WATER HAMMER WHERE NECESSARY.

PVC PIPE SCH. 40 SLEEVING, TWICE THE DIAMETER OF PIPE OR WIRE BUNDLE CARRIED - EXTEND 12" BEYOND EDGE OF PAVING & PLACE BELOW ALL PAVING, HARDSCAPE, ETC. AS DEPICTED ON PLAN OR REQUESTED BY HOMEOWNER.

IRRIGATION MISCELLANEOUS EQUIPMENT

NO SYMBOL

N/A

IRRIGATION 'COMMON' WIRE #14UF AWG DIRECT BURIAL

NO SYMBOL

N/A

IRRIGATION 'CONTROL' WIRE #14UF AWG DIRECT BURIAL

NO SYMBOL

N/A

IRRIGATION 'SPARE' WIRE #14UF AWG DIRECT BURIAL

NO SYMBOL

3M

DBR/Y-6 DIRECT BURIAL WATER-PROOF WIRE CONNECTORS FOR USE ON ALL WIRE CONNECTIONS